

ML-1101, ML-1102, ML-1103

MAXLOGIC INTELLIGENT ADDRESSABLE LOOP POWERED BASE SOUNDER, BEACON&SOUNDER AND BEACON

ML-110X Maxlogic intelligent addressable loop-powered **base sounder, beacon&sounder and beacon** are compatible with Maxlogic & Mavigard series intelligent addressable fire detectors, used with VIP communication protocol, aesthetic design and used to provide **sound and light notification of fire alarm** coming from the panel. It is an advanced product that offers superior operating performance. It is installed under the addressable detectors and gets its energy from the loop line. It can be programmed to operate in cause-effect scenarios.



PRODUCT FEATURES

- Compatible with **EN 54-3 and EN 54-23**
- Special design for indoor use
- Microprocessor controlled
- Easy addressing via Address programmer
- Easy programmable via Loop Manager + software
- Can be included to **cause-effect** scenarios
- Compatible with **Maxlogic & Mavigard** series detectors
- **8 different tone** options and **sound volume control**
- **0.5 Hz** flash frequency
- High sound intensity **75 dB**, low sound intensity **65 dB**
- Aesthetic design
- Produced by use of surface mount technology
- Easy to install and use
- Stable sensitivity and high operating conditions

MODELS

| Ürün Kodu | Açıklama |
|-----------|--|
| ML-1101 | Maxlogic Intelligent Addressable System Loop Powered Base Sounder |
| ML-1102 | Maxlogic Intelligent Addressable System Loop Powered Base Sounder & Beacon |
| ML-1103 | Maxlogic Intelligent Addressable System Loop Powered Base Beacon |

TECHNICAL SPECIFICATIONS

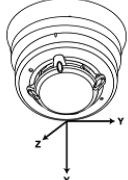
| Electrical Definitions | | | |
|--------------------------------|--|--|---|
| Models | ML-1101 | ML-1102 | M-L1103 |
| Power Supply Voltage | 18-33V DC Loop powered | | |
| Quiescent Current (max) | 500 μ A | 650 μ A | 550 μ A |
| Alarm current (max) | 3 mA | 10 mA | 9 mA |
| Power(max) | 0.10 W | 0.33 W | 0.30 W |
| Sound Definitions | | | |
| Sound intensity at 1m distance | High Sound Intensity: 75 dB(A) | | - |
| | Low Sound Intensity: 65 dB(A) | | - |
| Number of Tones | 8 | | - |
| Beacon Definitions | | | |
| Coverage Volume | - |  | Open Class; Y: 2.0 m Z: 2.0 m X: 0.45 m |
| Flash frequency | - | 0,5 Hz | 0,5 Hz |
| LED Color | - | White | White |
| Mechanical Definitions | | | |
| Material | ABS FR Flame Retardant (V0) | | |
| Dimensions (mm) | 114x32 | | |
| Weight | 125 gr | 125 gr | 125 gr |
| Mounting Type | Ceiling Type (Type A) | | |
| Body Color | White | | |
| Cable | 1x2x0.8+0.8JH(st)H / (1x2x1.5+1.5JH(st)H | | |
| Environmental Definitions | | | |
| Protection Class | IP21C | | |
| Operating temperature | (-10°C) - (+55°C) | | |
| Storage temperature | (-30°C) - (+60°C) | | |
| Max. relative humidity | %95 (+40°C non-condensing) | | |

SOUND MODELS

| No | Switch | | | Tone / Sound models | 1. fre. (Hz) | 2. fre. (Hz) | 1. On (ms) | 2. On (ms) | Off (ms) | Function |
|----|--------|---|---|---------------------|--------------|--------------|------------|------------|----------|----------|
| | 1 | 2 | 3 | | | | | | | |
| 1 | 0 | 0 | 0 | Alternating | 800 | 970 | 250 | 250 | - | Pulse |
| 2 | 1 | 0 | 0 | Continuous | 970 | - | ∞ | - | - | Steady |
| 3 | 0 | 1 | 0 | Pulse | 660 | - | 150 | - | 150 | Pulse |
| 4 | 1 | 1 | 0 | Sweep | 500 | 1200 | 3500 | - | 500 | Sweep |
| 5 | 0 | 0 | 1 | Sweep | 1200 | 500 | 1000 | - | - | Sweep |
| 6 | 1 | 0 | 1 | Pulse | 970 | - | 450-550 | - | 450-550 | Pulse |
| 7 | 0 | 1 | 1 | Continuous | 660 | - | ∞ | - | - | Steady |
| 8 | 1 | 1 | 1 | Continuous | 2850 | - | ∞ | - | - | Steady |

LIGHT COVERAGE AREA

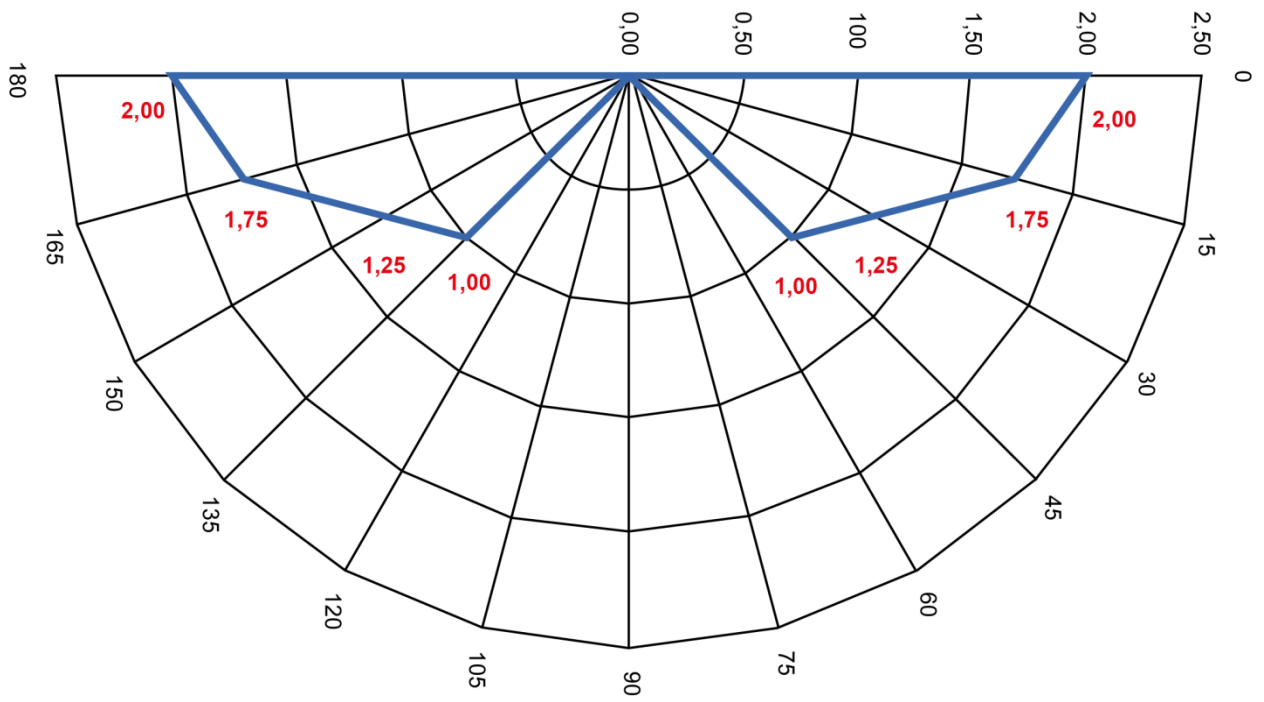

CONNECTION DIAGRAM

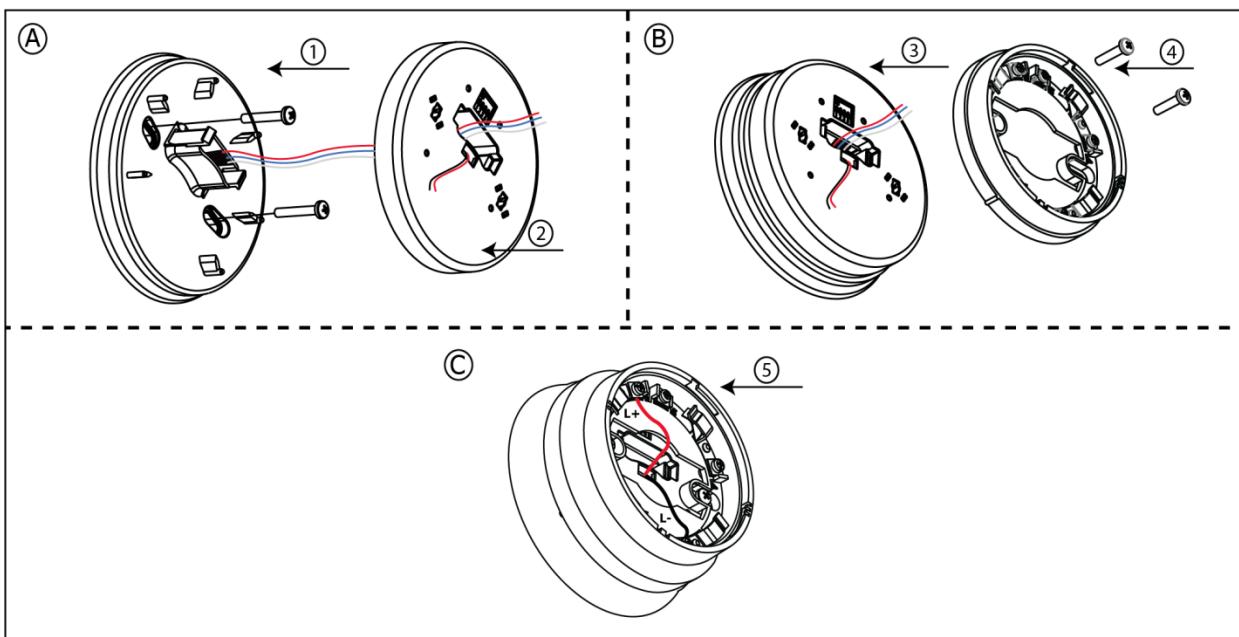

COMPATIBLE DEVICES

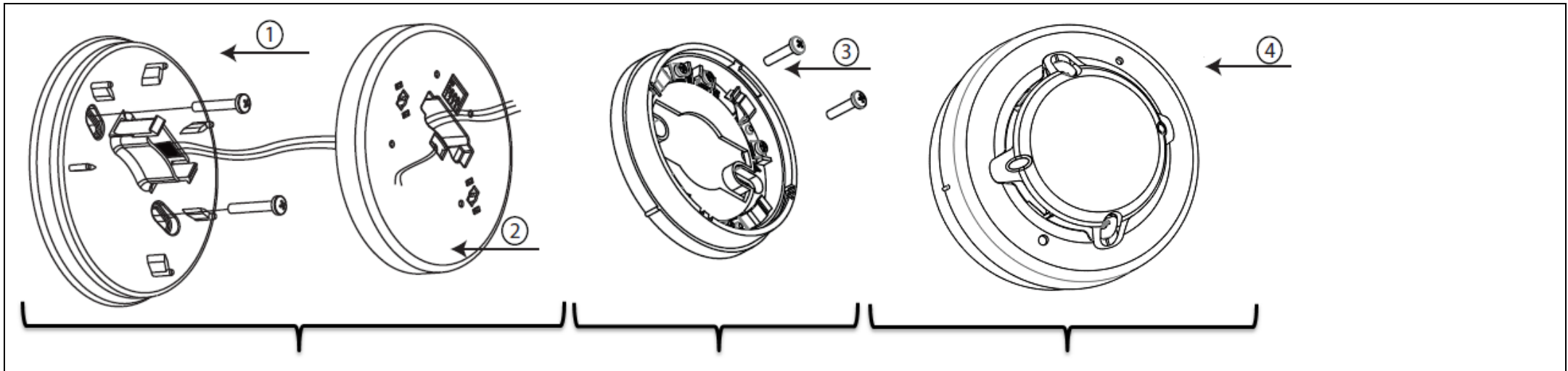

| Base Sounder / Beacon | Detector Base | Detector |
|--|--|--|
| | MG-3510 Mavigard Detector Mounting Base | MG-9100 Mavigard Intelligent Analogue Addressable Photo-Electric Smoke Detector MG-9300 Mavigard Intelligent Analogue Addressable Heat Detector MG-9400 Mavigard Intelligent Analogue Addressable Multisensor Detector (Photo-electric Smoke+Heat) |
| ML-1101 Maxlogic Intelligent Addressable System Loop Powered Base Sounder ML-1102 Maxlogic Intelligent Addressable System Loop Powered Base Sounder & Beacon ML-1103 Maxlogic Intelligent Addressable System Loop Powered Base Beacon | ML-0140 Maxlogic Detector Mounting Base | ML-1110 Maxlogic Intelligent Analogue Addressable System Smoke Detector ML-1120 Maxlogic Intelligent Analogue Addressable System A1S Fixed Temp Heat Detector ML-1130 Maxlogic Intelligent Analogue Addressable System A1R Rate of Rise Heat Detector ML-1130BS Maxlogic Intelligent Analogue Addressable System Class BS Heat Detector ML-1140 Maxlogic Intelligent Analogue Addressable System Multisensor (Photoelectric Smoke + Heat) Detector ML-1110.SCI Maxlogic Intelligent Analogue Addressable System Smoke Detector with Short Circuit Isolator ML-1120.SCI Maxlogic Intelligent Analogue Addressable System A1S Fixed Temp Heat Detector with Short Circuit Isolator ML-1130.SCI Maxlogic Intelligent Analogue Addressable System A1R Rate of Rise Heat Detector with Short Circuit Isolator ML-1140.SCI Maxlogic Intelligent Analogue Addressable System Multisensor (Photoelectric Smoke + Heat) Detector with Short Circuit Isolator |